

KOOKABURRA - TECHNICAL RIDER - 1/3

input list

| CH.no | Instruments | Mic | Routing F.O.H. | Inserts F.O.H. |
|-------|-------------|----------------------------------|----------------|----------------|
| 1 | Kick in | 91/e901 | Subgroup 1/2 | Gate |
| 2 | Snare top | sm57 | Subgroup 1/2 | |
| 3 | Hat | KM184 | Subgroup 1/2 | |
| 4 | Tom | Beta98 | Subgroup 1/2 | Gate |
| 5 | Floor | Beta98 | Subgroup 1/2 | Gate |
| 6 | OH < | KM184 | Subgroup 1/2 | |
| 7 | OH > | KM184 | Subgroup 1/2 | |
| 8 | Bass DI | DI | Subgroup 3/4 | |
| 9 | Bass Mic | MD421 | Subgroup 3/4 | |
| 10 | Guit | E906 | Subgroup 5/6 | |
| 11 | Guit | E906 | Subgroup 5/6 | |
| 12 | B Voc | SM58 | Subgroup 7/8 | |
| 13 | B Voc | E835 (own) | Subgroup 7/8 | |
| 14 | Voc Lead | E835 (own) | Subgroup 7/8 | |
| 15 | Voc Lead 2 | wireless EW 152 G3-B-EU (own) | Subgroup 7/8 | |

At larger venues, a little reverb on vocals and snare would be appreciated. Definitely NO delay on voice!

In any venue that does not technically exclude it or is not so small that there is no way to walk through it during a gig, lead vocals will use wireless headset microphone and in-ear monitoring (so 15 instead of 14). Sennheiser EW-series base stations for both provided by Kookaburra. In-ear monitoring needs 2 jackplug stereo ins (preferably with foh-endsound), wireless headset microphone base station connects through 1 XLR-microphone cable. Kookaburra provides power adapter for both base stations but needs 1 electric point for it. One of our guitarists uses simple jackplug wired in-ear monitoring and needs vocals (both backing and lead) on them.

KOOKABURRA - TECHNICAL RIDER - 2/3

monitor list

| Grp.No. | Instruments | Insert |
|---------|----------------------------------|--------|
| 1 | Drums | |
| 2 | Lead vocals < | |
| 3 | Lead vocals > | |
| 4 | Bass | |
| 5 | Guitar / Backing vocals | |
| 6 | Guitar / Backing vocals (in ear) | |
| 7 | Lead vocals (in ear) | |

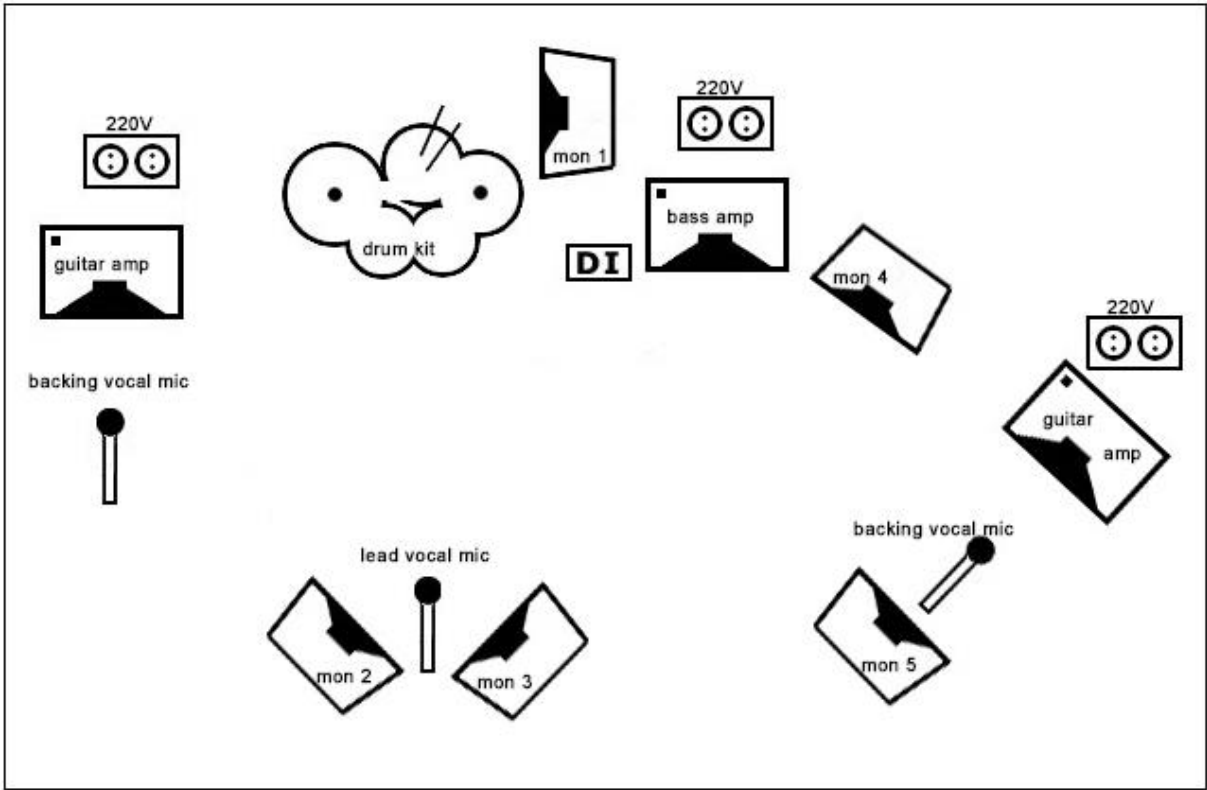

KOOKABURRA - TECHNICAL RIDER - 3/3

General

Band members:

Frits de Haan - guitar, backing vocals

Lester Brunt - drums

Tjeerd Gunning - bass

Chielie - lead vocals

Pim Kruijt - guitar, backing vocals

PA/Backline

No limiters shall be placed in the signal path!

Guitar signal will be routed through amplifier, not venue sound system!